



M243 Addition and alterations to Hous'hill

Introduction

Mackintosh designed decorative schemes for the interiors in 1904–5, and in 1908–10 returned to carry out architectural work and additional interior decoration for Miss Catherine (Kate) Cranston and her husband, John Cochrane. Hous'hill dated originally from the 17th century, was extended in the early 19th century by noted West of Scotland architect, David Hamilton, and by an unidentified architect before 1870.

Authorship: Original drawings in Mackintosh's hand survive for the 1904–5 furniture and decoration, and for the additions and alterations in 1908–10. ¹ Mackintosh is named in the 1907 *Studio Yearbook* as designer of the 1904–6 interior schemes. ²

Cost from job book: Phase 1: £1422 0s 7d; Phase 2: £1237 16s 6d

Status: Demolished

RCAHMS Site Number: NS56SW 144

Grid reference: NS 5256 6124

Chronology

1710

'Househill' described as a 'neat and handsome dwelling'. ¹

1818

'Househill' described as a 'handsome mansion'. ²

By 1831

Late Georgian addition to existing house including a bowed, two-storey wing by David Hamilton for which four drawings survive. An amateur sketch of 'Househill' showing the bow was published in 1831, when it was described as the 'largest private house on the Levern'. ³

1858

O.S. map shows the Hamilton addition and a second bowed wing with an open centre extending from the N.E. elevation. ⁴

1870

A photograph by Thomas Annan in *The Old Glasgow Houses of the Old Glasgow Gentry* shows a new conical-roofed tower on the N.W. elevation. ⁵

1904

16 May: Earliest contractor tender accepted. ⁶

1905

January–June: Majority of contractors paid. ⁷

1906

'The House Hill' photographed by Henry Bedford Lemere. ⁸

1908

January: Sheet of plans are drawn up. ⁹

July: Sheet of elevations and section are drawn up. ¹⁰

5 August: Approval granted for alterations. ¹¹

9 September: Contractor tenders accepted. ¹²

1909

25 May: Earliest payments to contractors. ¹³

June: Date of Mackintosh drawing for card tables. ¹⁴

Two drawings exhibited under Mackintosh's name at Glasgow Institute of the Fine Arts. ¹⁵

1910

17 November: Latest payment to contractors. ¹⁶

1934

5 July: Fire severely damages first and second (attic) floors. ¹⁷

5 October: At a meeting of Glasgow Corporation Housing Department's sites and buildings sub-committee, the Town Clerk reports on negotiations between the District Valuer of Inland Revenue and solicitors MacKenzie, Robertson & Co., acting on behalf of the Trustees of John W. Henderson (owner) associated with the proposed acquisition by the Corporation of 'Househill and its lands'. At this meeting the sub-committee agrees to the purchase of 91 acres of land at Househillwood adjacent to Barrhead Road, and immediately E. of Hous'hill across the Lavern Water. ¹⁸

1935

26 November: Glasgow Dean of Guild Court grants approval for a housing estate at Househillwood. ¹⁹

1937

8 January: At a meeting of Glasgow Corporation Housing Department's sites and buildings sub-committee details of a provisional settlement with the Trustees of John W. Henderson are outlined. The purchase of 'Househill and its lands' is recommended. An entry date to the house and grounds of 2 February 1937 is included in the terms of the settlement. ²⁰

3 December: At the monthly meeting of Glasgow Corporation Housing Department's sites and buildings sub-committee the Director of Parks presents plans for the 'proposed development of the policies of Househill as a small park or open space'. The plans are approved. The wording of the minutes suggests the house has been demolished by this date. ²¹

1938

O.S. map: Hous'hill's grounds and gardens are shown but the house has gone. The new Househillwood housing estate nearby is shown. ²²

1939

11 May: A report submitted to Glasgow Corporation Housing Department's sites and buildings sub-committee describes the work for Househill Park as nearing completion. ²³

Description

Origins

In late 1903 or early 1904 Glasgow tea room proprietor Miss Catherine (Kate) Cranston and her husband, John Cochrane, an iron-foundry owner and Provost of Barrhead, began renting 'Househill' (as it was always named on O.S. maps), a large country house at Nitshill, S. of Glasgow. ¹ Apparently known locally as 'Howsele' or 'Hoozel' – which may explain Mackintosh's rendering of the name as 'Hous'hill' – the house appears to date back to at least 1646, when it and its estate were bought by a Thomas Dunlop from the Stewart of Minto family. ²

During the 19th century the house was extended and altered. Before 1831, the noted architect David Hamilton designed a late Georgian-style addition, including a bowed, two-storey wing. ³

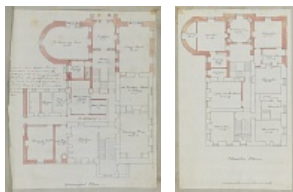

Then, between 1858 and 1870, the arrangement of its W. side was fundamentally altered and a Scots-Baronial, conical-roofed tower was constructed in a new internal angle. ⁴ It is not clear if by 1904 any of the early fabric of the house remained.



Commission

By 1904 when she commissioned Mackintosh to redecorate her new home, Kate Cranston had established herself as one of his most important patrons: his fourth tea-room commission for her, the Willow Tea Rooms, had recently opened. Between 1904 and 1906, he was responsible for a reception/music room, a

dining room, two bedrooms (known as the white bedroom and blue bedroom), a billiard room, and the entrance hall and stairs. ⁵

Two years later Mackintosh returned to Hous'hill to carry out further interior work and some structural alterations and additions. The house was demolished in 1937 and only one exterior photograph of this work survives: thus the plans of January and elevations and section of July 1908, signed but not drawn by Mackintosh, are the only indication of the architectural work proposed. Furniture and drawings for the interior also survive. ⁶ The 1908 drawings show several additions and alterations: a two-storey, flat-roofed bay is added to the S. elevation, with a dormer window on the roof directly above; the roof of the neo-classical portico on the E. elevation is transformed into a balcony with railings; the servants' hall becomes a ground-floor reception room, the card room, with additional fireplace and chimney, and alterations for doorways; the service quarters on the W. side of the ground floor are reorganised and include a new servants' hall, a refitted butler's pantry, chimney and windows; a first-floor bathroom with window, incorporating the chimney, is created from the thick masonry wall between the white and blue bedrooms; the attic rooms are reorganised to correspond to the dormer window and to incorporate the new chimney. ⁷

Exterior

A shallow, S.-facing rectangular bay was added to the lower-ceilinged W. section of the house, which extended the new ground-floor card room and the first-floor white bedroom. The bay was glazed with leaded, metal-framed casements on all three sides and the walls were roughcast. Two rolled-steel beams were inserted across the new opening in the exterior wall for structural support. In its form, materials and central location on a garden elevation the bay is reminiscent of those at The Hill House and Windyhill. Potential sources for all three bays can be found in the pages of Mackintosh's mid-1890s travel sketchbooks, such as traditional rectangular bays with leaded glazing on 17th-century buildings in Lyme Regis, Dorset. ⁸ However, the bay provided a marked contrast with the existing, partly Georgian, S. facade of Hous'hill.

The unusual balcony above the entrance portico on the E. elevation was accessed from the octagonal room on the first floor. The elevation shows that he intended the Georgian window above the portico to be altered to accommodate a glass door, apparently leaded, and the 'wooden top of porch [to be] flattened with railing to make [a] sitting out balcony'. According to annotations on the plan, the floor of the balcony was to be laid with lead and the balustrade was to be wooden and run behind the existing stone pediment. The majority of the balcony work appears to have been carried out by James Grant. An ironwork pergola made by Bryden & Middleton, described on the drawing as a 'screen', was to stretch up from the sides and over the balcony at the height of the facade cornice. ⁹



Interior

The title 'Card Room' does not appear on the January 1908 ground-floor plan, but appears in the job-book entry for the 1908–10 work and from Mackintosh's drawings for furniture of 1909. ¹⁰ The former servants' hall located between the billiard room and the kitchen became the card room and was enlarged with the addition of a glazed bay. A new, second, fireplace was inserted into the thick W. wall. The change in function and status of the room was indicated by the blocking up of the doorway to the kitchen in the W. wall and the opening up of the two cupboards in the E. wall to provide access to the billiard room, so creating what has been described as a 'games suite'. ¹¹ Unlike billiard rooms at comparable private houses or at public tea rooms, the Cranston–Cochrane billiard room was not provided with its own entrance or cloakroom facilities.



The fireplace of the new card room was decorated with pieces of thick plate glass set horizontally, and the walls with gold leaf. ¹² A new cast-iron grate, probably designed for this fireplace, included the date 1909 between the initials 'JC' and 'CC'. Mackintosh repeated this use of clients' initials seven years later in the grate for the lounge-hall at 78 Derngate, Northampton. ¹³ Furniture and fittings for the card room included four tables, chairs and a 'centre stand'; a writing table and two chairs thought to be intended for the window bay; and four small gesso panels of the queens of the four card suits designed and made by Margaret Macdonald. ¹⁴ The number of tables, the central stand and the convivial social aspect of card parties in this recreation room in a private country house is comparable to the layout and function of Miss Cranston's public, urban tea rooms. ¹⁵

Later history

John Cochrane died in 1917. Two years later Kate Cranston left Hous'hill for the North British Railway Hotel in George Square, Glasgow. ¹⁶ The Mackintosh furniture remained in the house. The Mackintosh interiors then passed into the hands of the new tenant, Edward Arthur Gamble. In 1926, Hous'hill was purchased by Glasgow lawyer John W. Henderson, and Gamble took the Mackintosh furniture with him to his new home. This furniture was offered for sale by J. & R. Edmiston, auctioneers, on 13 May 1933. ¹⁷

On 5 July 1934 a fire caused extensive damage to the first and second floors of the house. Around four months later negotiations between a District Valuer of Inland Revenue and solicitors MacKenzie, Robertson & Co., acting on behalf of the Trustees of John W. Henderson, were under way on a proposed acquisition for the Corporation of 'Househill and its lands'. In October 1934 the purchase of 91 acres at Househillwood, immediately E. of and across the Levern Water from Hous'hill, was recommended. ¹⁸ By January 1937 details of a purchase settlement had been drawn up, with an entry date to the house and grounds for the Corporation of 2 February 1937. ¹⁹ In December 1937, plans for the redevelopment of Hous'hill's grounds into a park were proposed; this

work was nearing completion in May 1939. ²⁰



The 1938 O.S. map confirms that Hous'hill had been demolished by this date; however, the layout of its formal gardens and grounds appeared unchanged. The new Househillwood housing estate is shown immediately to the E. ²¹

People

Clients:

- John Cochrane
- Miss Catherine (Kate) Cranston

Contractors:

- James Brown
- Bryden & Middleton
- Burroughs & Watts
- Crawford & Craig
- Peter Wylie Davidson
- William Douglas
- John Findlay & Co.
- James Grant
- David Hislop
- Hope Brothers
- Hugh Houston
- Andrew Hutcheson
- Alex Martin
- McCulloch & Co.
- Margaret Macdonald
- Murray, McVinnie & Co.
- Osler & Co.
- J. Caird Parker
- Paterson Brothers
- Potier, Stewart & Hardie
- Scottish Guild of Handicraft
- The Scottish Patent Flooring Co.
- Shaw & Walker
- Thomas Siddon
- Francis Smith
- George Walton
- Wylie & Lochhead

Job Book

The job books of Honeyman & Keppie (later Honeyman, Keppie & Mackintosh) are now held by The Hunterian, University of Glasgow and include four volumes related to the Mackintosh period. The books were used by the firm to keep a project-by-project, day-by-day record of contractors, suppliers and expenditure. The name of a project and/or client is usually at the top of the left-hand page, followed by information about tradesmen who tendered. The name of the measurer (quantity surveyor) is usually at the top of the right-hand page, followed by information about payments to contractors and suppliers. All of the data for M243 is entered in the tables below.

Page numbering is not consistent in the job books. Sometimes a single number refers to a double-page spread and sometimes each page is individually numbered. Here, each image of a double-page spread is identified by the number given at the top of the left-hand page. (Images of all of the pages from the four job books can be found at [Browse Job Books](#), [Visit Book and Cash Book](#).)

The following information about M243 has been extracted from the job books:



Tenders:

Contractor	Type	Address	Date	Value	Accepted
Burroughs & Watts	billiard table	no data in job book	no data in job book	£101 10s 0d ¹	yes (16 May 1904)
James Grant	seats	no data in job book	no data in job book	£24 0s 0d ²	yes (16 May 1904)
Francis Smith	furniture	no data in job book	no data in job book	£10 2s 6d ³	yes (16 May 1904)
Wylie & Lochhead	carpet	no data in job book	no data in job book	£20 5s 0d	yes (25 July 1904)
James Brown	light fittings	no data in job book	no data in job book	£1 17s 6d ⁴	yes (25 July 1904)
James Grant	billiard room fittings	no data in job book	no data in job book	no data in job book	yes (25 July 1904)
McCulloch & Co.	glazier	no data in job book	no data in job book	£35 1s 0d ⁵	yes (25 July 1904)
McCulloch & Co.	glazier	no data in job book	no data in job book	£7 0s 0d ⁶	yes (29 September 1904)
McCulloch & Co.	glazier	no data in job book	no data in job book	£1 2s 6d ⁷	yes (12 October 1904)
McCulloch & Co.	glazier	no data in job book	no data in job book	£1 2s 6d ⁸	yes (18 October 1904)
McCulloch & Co.	glazier	no data in job book	no data in job book	£3 5s 0d ⁹	yes (19 October 1904)
McCulloch & Co.	glazier	no data in job book	no data in job book	no data in job book ¹⁰	yes (20 October 1904)
J. Caird Parker	grates & fireplace fittings	no data in job book	no data in job book	£34 6s 0d ¹¹	yes (21 July 1904)
James Brown	lamps	no data in job book	no data in job book	£13 2s 6d ¹²	yes (21 July 1904)
Andrew Hutcheson	metalwork	no data in job book	no data in job book	£1 16s 0d ¹³	no (21 July 1904)
Thomas Siddon	lamps and glass beads	no data in job book	no data in job book	£1 13s 0d ¹⁴	yes (21 July 1904)
George Walton	curtains and counterpanes	no data in job book	no data in job book	£21 2s 9d ¹⁵	yes (21 July 1904)
Francis Smith	furniture for Blue Bedroom	no data in job book	no data in job book	£70 15s 0d ¹⁶	yes (21 July 1904)
Wylie & Lochhead	carpets and rugs	no data in job book	no data in job book	£15 5s 6d	yes (21 July 1904)
John Findlay & Co.	basins and jugs	no data in job book	no data in job book	£13 16s 6d ¹⁷	yes (21 July 1904)
David Hislop	fittings?	no data in job book	no data in job book	£4 18s 3d ¹⁸	yes (21 July 1904)
Alex Martin	fittings?	no data in job book	no data in job book	no data in job book	no ()
Wylie & Lochhead	carpets	no data in job book	no data in job book	no data in job book ¹⁹	yes (20 October 1904)
Scottish Guild of Handicraft	ceramic ware	no data in job book	no data in job book	12s 0d ²⁰	yes (20 October 1904)
Alex Martin	furniture for White Bedroom	no data in job book	no data in job book	£88 18s 0d ²¹	yes (20 October 1904)

Wylie & Lochhead	carpets and rugs	no data in job book	no data in job book	£7 8s 6d	yes (20 October 1904)
James Grant	joiner	no data in job book	no data in job book	£5 5s 0d ²²	yes (20 October 1904)
Alex Martin	candlesticks	no data in job book	no data in job book	no data in job book	yes (20 October 1904)
Alex Martin	furniture	no data in job book	no data in job book	£5 10s 0d ²³	yes (1 August [1904])
James Grant	furniture	no data in job book	no data in job book	£23 15s 0d ²⁴	yes (1 and 2 August [1904])
William Douglas	painter	no data in job book	no data in job book	£177 0s 0d	yes (3 August [1904])
Paterson Brothers	plumber	no data in job book	no data in job book	£32 0s 0d	yes (4 August [1904])
Hugh Houston	mason	no data in job book	no data in job book	no data in job book ²⁵	yes (4 August [1904])
Alex Martin	furniture	no data in job book	no data in job book	£46 0s 0d ²⁶	yes (9 August [1904])
Wylie & Lochhead	drawing room carpet	no data in job book	no data in job book	no data in job book	yes (16 August [1904])
Alex Martin	drawing room cupboard	no data in job book	no data in job book	£17 0s 0d	no data in job book ()
James Grant	drawing room cupboard	no data in job book	no data in job book	£8 10s 0d	no data in job book ()
Alex Martin	furniture	no data in job book	no data in job book	£11 0s 0d ²⁷	yes (1 November [1904])
James Grant	fittings	no data in job book	no data in job book	no data in job book	yes (no data in job book)
Francis Smith	linoleum	no data in job book	no data in job book	no data in job book	yes (no data in job book)
Andrew Hutcheson	dining room pendant	no data in job book	no data in job book	£22 10s 0d	yes (16 December 1904)
Francis Smith	hall table and rack	no data in job book	no data in job book	£10 7s 6d	yes (19 December 1904)
Wylie & Lochhead	carpets	no data in job book	no data in job book	£41 18s 3d ²⁸	yes (30 January 1905)
Crawford & Craig	cushions	no data in job book	no data in job book	no data in job book ²⁹	yes (1905)
James Grant	furniture	no data in job book	no data in job book	no data in job book ³⁰	yes (8 March 1905)
Andrew Hutcheson	towel rail in Blue Bedroom	no data in job book	no data in job book	£6 0s 0d	yes (8 March 1905)
Francis Smith	2 chairs for Blue Bedroom	no data in job book	no data in job book	£19 0s 0d	yes (11 April 1905)
Alex Martin	2 pen boxes	no data in job book	no data in job book	£4 15s 0d	yes (11 April 1905)
James Grant	furniture	no data in job book	no data in job book	£22 12s 0d ³¹	yes (11 May 1905)

Payments (trades):

Name	Type	Payment out sum

Burroughs & Watts	billiard table	Payment date: 20 October 1904 £101 10s 0d
James Grant	billiard room fittings	Payment date: 30 November 1904 £35 5s ½d
Francis Smith	furniture	Payment date: 15 December 1904 £24 12s 6d
Francis Smith	carpet	Payment date: 19 December 1904 £20 3s 6d ³²
Wylie & Lochhead	carpet	Payment date: 29 January 1905 £20 5s 0d ³³
McCulloch & Co.	glazier	Payment date: 12 January 1905 £79 1s 0d ³⁴
J. Caird Parker	grates & fenders	Payment date: 16 December 1904 £52 14s 3d ³⁵
James Brown	lamps	Payment date: 25 January 1905 £30 0s 6d ³⁶
Wylie & Lochhead	carpet	Payment date: 29 January 1905 £18 18s 6d ³⁷
Crawford & Craig	window screens	Payment date: 29 January 1905 £2 12s 6d ³⁸
Thomas Siddon	lamps and glass beads	Payment date: 16 September; 31 October 1904 £3 17s 8d
James Grant	joiner	Payment date: 30 November 1904 £63 9s 3d ³⁹
George Walton	curtains and counterpanes	Payment date: 3 February 1905 £21 2s 9d
Crawford & Craig	cushions	Payment date: [15 December 1904] £10 7s 0d ⁴⁰
Francis Smith	furniture	Payment date: 15 December 1904 £96 16s 0d ⁴¹
Alex Martin	candlesticks	Payment date: 17 December 1904 £1 17s 6d ⁴²
Wylie & Lochhead	rug	Payment date: 24 January 1905 £13 17s 6d ⁴³
James Grant	joiner	Payment date: 30 November 1904 £7 4s 3½d ⁴⁴
John Findlay & Co.	basins and jugs	Payment date: 28 December 1904 £13 16s 0d ⁴⁵
David Hislop	candlesticks	Payment date: 6 December 1904 £2 14s 6d ⁴⁶
Crawford & Craig	curtains and sheets	Payment date: 30 January 1905 £19 9s 8d ⁴⁷
Hugh Houston	mason	Payment date: 6 February 1905 £51 0s 5d ⁴⁸
Paterson Brothers	plumber	Payment date: 9 February 1905 £36 3s 0d
Scottish Guild of Handicraft	ceramic ware	Payment date: 13 January 1905 £1 4s 0d ⁴⁹
David Hislop	fittings	Payment date: 23 March 1905 14s 3d ⁵⁰
Alex Martin	furniture	Payment date: 17 December 1904 £94 15s 0d ⁵¹
James Grant	joiner	Payment date: 30 November 1904 £6 9s 0d ⁵²
Wylie & Lochhead	rugs and pillows	Payment date: 24 January 1905 £11 2s 6d ⁵³

Alex Martin	furniture	Payment date: 17 December 1904 £47 18s 0d ⁵⁴
William Douglas	painter	First installment: 5 November 1904 Final installment: 2 March 1905 £209 0s 2d
Alex Martin	furniture	Payment date: 17 December 1904 £40 18s 0d ⁵⁵
Crawford & Craig	curtains and sheets	Payment date: 17 December 1904 £7 10s 0d ⁵⁶
James Grant	joiner	Payment date: 30 November 1904 £26 12s 6d ⁵⁷
Francis Smith	furnishings	Payment date: 16 December 1904 £29 13s 1d ⁵⁸
Andrew Hutcheson	lamps	Payment date: 10 May 1905 £22 10s 0d ⁵⁹
Francis Smith	furniture	Payment date: 28 June 1905 £10 7s 6d ⁶⁰
Wylie & Lochhead	carpets	Payment date: [28 June 1905] £42 3s 9d ⁶¹
Crawford & Craig	cushions	Payment date: 7 April 1905 £10 7s 0d ⁶²
Andrew Hutcheson	towel rails	Payment date: 10 May 1905 £6 0s 0d ⁶³
Francis Smith	furniture	Payment date: 28 June 1905 £17 0s 0d ⁶⁴
James Grant	fittings	Payment date: 11 May 1905 £1 3s 0d ⁶⁵
Andrew Hutcheson	lamps	Payment date: 11 May 1905 £68 8s 6d ⁶⁶
J. Caird Parker	grates and fire irons	Payment date: 15 May 1905 £14 6s 9d ⁶⁷
Andrew Hutcheson	lamps	Payment date: 6 August 1906 £25 7s 3d ⁶⁸

Payments (suppliers):

Name	Service	Payment date	Payment sum
no data in job book	'24 yards hand loom linen'	29 December 1904	£6 12s 0d

Phase 2: Structural additions and alterations, and interior decoration, 1908–10



Job book: 53063
Page: 1



Job book: 53063
Page: 13

Tenders:

Contractor	Type	Address	Date	Value	Accepted
James Grant	pantry fittings	no data in job book	1908	£34 0s 0d	yes (9 September 1908)
Hugh Houston	mason	no data in job book	1908	£144 7s 0d ⁶⁹	yes (9 September 1908)

James Grant	joiner	no data in job book	1908	£229 14s 2d ⁷⁰	yes (9 September 1908)
James Grant	joiner	no data in job book	1908	£111 8s 11d ⁷¹	yes (9 September 1908)
Paterson Brothers	plumber	no data in job book	1908	£127 10s 0d	yes (9 September 1908)
Wylie & Lochhead	Card Room tables	no data in job book	1909	'4 @ £5 15/- each'	no
Francis Smith	Card Room tables	no data in job book	1909	£22 12s 0d ⁷²	yes (27 July 1909)
The Scottish Patent Flooring Co.	flooring	no data in job book	1909	£26 12s 0d ⁷³	yes (30 July 1909)
Murray, McVinnie & Co.	flooring	no data in job book	1909	no data in job book ⁷⁴	yes (30 July 1909)
J. Caird Parker	Card Room grate	no data in job book	1909	£23 14s 12d ⁷⁵	yes (3 July 1909)
Shaw & Walker	tiler	no data in job book	1909	£8 15s 2d ⁷⁶	yes (24 March 1909)
Bryden & Middleton	fittings	no data in job book	1909	£4 13s 10d ⁷⁷	yes (26 April 1909)
Potier, Stewart & Hardie	light fittings	no data in job book	1909	£21 15s 0d ⁷⁸	yes (26 April 1909)
Francis Smith	furniture	no data in job book	1909	£11 15s 0d ⁷⁹	yes (9 November 1909)
Hope Brothers	fittings	no data in job book	no data in job book	13s 6d ⁸⁰	yes (24 January 1910)
Peter Wylie Davidson	fittings	no data in job book	no data in job book	no data in job book ⁸¹	yes (19 February 1910)
Margaret Macdonald	fittings	no data in job book	1910 no data in job book	£50 0s 0d ⁸²	yes (4 March 1910)
Peter Wylie Davidson	fittings	no data in job book	1910	£14 10s 0d ⁸³	yes (9 November 1910)
Scottish Guild of Handicraft	fittings	no data in job book	1910	£3 15s 0d ⁸⁴	yes (9 November 1910)

Payments (trades):



Name	Type	Payment out sum
Hugh Houston	mason	First installment: 25 May 1909 Final installment: 17 January 1910 £374 14s 9½d
James Grant	joiner	First installment: 25 May 1909 Final installment: 14 November 1910 £489 3s 2½d ⁸⁵
Paterson Brothers	plumber	First installment: 30 June 1909 Final installment: 18 January 1910 £253 14s 6d
Francis Smith	furniture	Payment date: 7 June 1910 £115 4s 1d
The Scottish Patent Flooring Co.	flooring	Payment date: 13 December [1909] £35 6s 0d

Murray, McVinnie & Co.	flooring	Payment date: 16 December [1909] £34 10s 0d
J. Caird Parker	grates	Payment date: 26 March 1910 £35 6s 1d ⁸⁶
Shaw & Walker	tiler	Payment date: 8 July 1909 £8 15s 2d
Bryden & Middleton	fittings	Payment date: 15 November 1909 £4 13s 10d
Osler & Co. per Potier, Stewart & Hardie	light fittings	Payment date: 28 September 1909 £26 6s 9d
Paterson Brothers	light fittings	Payment date: 28 September 1909 £2 3s 6d ⁸⁷
Hope Brothers	fittings	Payment date: no data in job book 13s 6d
Peter Wylie Davidson	fittings	Payment date: 19 February 1910 £8 8s 0d ⁸⁸
Margaret Macdonald	fittings	Payment date: 4 March 1910 £50 0s 0d ⁸⁹
Peter Wylie Davidson	fittings	Payment date: 8 November 1910 £14 10s 10d
Scottish Guild of Handicraft	fittings	Payment date: 17 November 1910 £3 15s 0d ⁹⁰



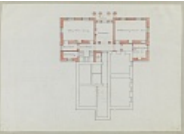

Payments (suppliers):

Name	Service	Payment date	Payment sum
William Douglas	no data in job book	28 September 1910	£187 11s 3d ⁹¹

Documents

			
Ground-floor plan showing David Hamilton's proposed additions and alterations, before 1831	First-floor plan showing David Hamilton's proposed additions and alterations, before 1831	Ground-floor plan showing David Hamilton's alternative proposal for additions and alterations, before 1831	Ground-floor plan showing David Hamilton's second alternative proposal for additions and alterations, before 1831

Images

			
Conical-roofed tower on N.W. elevation, c. 1930s	S. elevation with two-storey bay, c. 1930s	Portico with iron trellis on its roof, c. 1930s	Ground-floor plan

Bibliography

Published

- Roger Billcliffe, *Charles Rennie Mackintosh: The Complete Furniture, Furniture Drawings and Interior Designs*, Moffat, Dumfriesshire: Cameron & Hollis, 4th edn, 2009, pp. 195–216; pp. 244–8
- Alan Crawford, *Charles Rennie Mackintosh*, London: Thames & Hudson, 1995, p. 124–129
- Thomas Howarth, *Charles Rennie Mackintosh and the Modern Movement*, London: Routledge & Kegan Paul, 2nd edn, 1977, pp. 113–7; 225
- Perilla Kinchin, *Miss Cranston: Patron of Charles Rennie Mackintosh*, Edinburgh: National Museums of Scotland, 1999
- Robert Macleod, *Charles Rennie Mackintosh: Architect and Artist*, London: Collins, 1983, pp. 117–8
- James Macaulay, *Charles Rennie Mackintosh*, New York: W. W. Norton, 2010, pp. 251–2
- Frank Worsdall, *The City that Disappeared: Glasgow's Demolished Architecture* Glasgow: Richard Drew Publishing, 1981, pp. 31–2
- Peter Wylie Davidson, 'Memories of Mackintosh', *Charles Rennie Mackintosh Society Newsletter*, Summer 1979, pp. 4–6
- Emily V. Davis, 'Mackintosh, Hous-hill and the mysterious Card Room', *Charles Rennie Mackintosh Society Newsletter*, 87, Autumn 2004, pp. 6–9
- John Weyers, 'Kate Cranston and the Mackintosh Connection', *Glasgow Herald*, 6 June 1981, 'Weekender' supplement, p. 7
- *Evening Times*, 6 July 1934, p. 6
- *Glasgow Herald*, 6 July 1934, pp. 5 (ill.), 11
- *Paisley Gazette*, 7 July 1934
- *The Studio Yearbook of Decorative Art*, 1907, pp. 58–60
- *The Studio Yearbook of Decorative Art*, 1917, p. 79

Unpublished

- Hiroaki Kimura, 'Charles Rennie Mackintosh: Architectural Drawings Catalogue and Design Analytical Catalogue', University of Glasgow: unpublished PhD thesis, 1982, pp. 49–50, 200–2
- Paisley, Renfrewshire Council Planning Department: County of Renfrew, First or Upper District, Register of New Buildings 1898–1910, no. 1228, p. 68

Notes:

- 1: There are more than 40 drawings for Hous-hill furniture and decoration in the The Hunterian, University of Glasgow collection; and architectural drawings in the Glasgow School of Art Archive: plans, sections and elevations, MC:G47 and MC:G48 (M243-002 and M243-001).
- 2: *The Studio Yearbook of Decorative Art*, 1907, pp. 58–60.
- 3: George Crawford, *General Description of the Shire of Renfrew, 1710. Continuation to the Present Day by George Robertson, 1818*, Paisley: J. Neilson, 1818, p. 45.
- 4: George Crawford, *General Description of the Shire of Renfrew, 1710. Continuation to the Present Day by George Robertson, 1818*, Paisley: J. Neilson, 1818, p. 310.
- 5: The Hunterian, University of Glasgow: GLAHA 42880; GLAHA 42881; GLAHA 42882; GLAHA 42891; C. Taylor, *The Levern Delineated in a Series of Most Interesting Scenery*, 1831, pp. 82–3.
- 6: O.S., Renfrewshire XII.12 (Combined) (25 inch, 1st edn, 1858–64).
- 7: John Guthrie Smith and John Oswald Mitchell, *The Old Glasgow Houses of the Old Glasgow Gentry*, Glasgow: James MacLehose & Sons, 1870, no. 57 (unpaginated).
- 8: The Hunterian, University of Glasgow: Honeyman, Keppie & Mackintosh job book, GLAHA 53062, p. 60.
- 9: The Hunterian, University of Glasgow: Honeyman, Keppie & Mackintosh job book, GLAHA 53062, pp. 59–63, 81.
- 10: National Monument Register, Swindon: Henry Bedford Lemere, Day Book 5, HBL 01/05, p. 216, negative nos. 19441–52; The Hunterian, University of Glasgow: GLAHA 52599; GLAHA 52600; GLAHA 52601; GLAHA 52602; GLAHA 52603.
- 11: Glasgow School of Art Archive: plans, MC:G48 (M243-001).
- 12: Glasgow School of Art Archive: elevations and sections, MC:G47 (M243-002).
- 13: Paisley, Renfrewshire Council Planning Department: County of Renfrew, First or Upper District, Register of New Buildings 1898–1910, no. 1228, p. 68.
- 14: The Hunterian, University of Glasgow: Honeyman Keppie & Mackintosh job book, GLAHA 53063, p. 1.
- 15: The Hunterian, University of Glasgow: Honeyman Keppie & Mackintosh job book, GLAHA 53063, p. 12.
- 16: The Hunterian, University of Glasgow: GLAHA 41112.
- 17: Royal Glasgow Institute of the Fine Arts, 1909 (686 and 690).
- 18: The Hunterian, University of Glasgow: Honeyman Keppie & Mackintosh job book, GLAHA 53063, p. 13.

- 19: *Glasgow Herald*, 6 July 1934, p. 11 (ill. p. 5); *Evening Times*, 6 July 1934, p. 6; *Paisley Gazette*, 7 July 1934.
- 20: Glasgow City Archives Collection: Glasgow Corporation, Housing Department, sites and building sub-committee minutes, C1/3/93, 5 October 1934.
- 21: Glasgow City Archives Collection: Glasgow Dean of Guild plans, B4/12/1935/480.
- 22: Glasgow City Archives Collection: Glasgow Corporation, Housing Department, sites and building sub-committee minutes, C1/3/96, 8 January 1937.
- 23: Glasgow City Archives Collection: Glasgow Corporation, Housing Department, sites and building sub-committee minutes, C1/3/97, 3 December 1937.
- 24: O.S., Renfrewshire XII.SE (County Series 1:10560, 3rd revision, 1938–47).
- 25: Glasgow City Archives Collection: Glasgow Corporation, Housing Department, sites and building sub-committee minutes, C1/3/100, 19 May 1939.
- 26: Roger Billcliffe, *Charles Rennie Mackintosh: The Complete Furniture, Furniture Drawings and Interior Designs*, Moffat, Dumfriesshire: Cameron & Hollis, 4th edn, 2009, p.193. See for instance, O.S., Renfrewshire XII.12 (Combined) (25 inch, 1st edn, 1858–64) and O.S., Renfrewshire XII.SE (County Series 1:10560, 3rd revision, 1938–47).
- 27: The pronunciation 'Howse' and the the lands of 'Househill' are documented as early as the 1470s according to John Guthrie Smith and John Oswald Mitchell, *The Old Glasgow Houses of the Old Glasgow Gentry*, Glasgow: James MacLehose & Sons, 1870, no. 57 (unpaginated); the pronunciation 'Hoozel' is suggested in John Weyers, 'Kate Cranston and the Mackintosh Connection', *Glasgow Herald*, 6 June 1981, 'Weekender' supplement, p. 7.
- 28: The Hunterian, University of Glasgow: GLAHA 42880; GLAHA 42881; GLAHA 42882; GLAHA 42891; C. Taylor, *The Levern Delineated in a Series of Most Interesting Scenery*, 1831, pp. 82–3.
- 29: The earlier form of the house can be seen on O.S., Renfrewshire XII.12 (Combined) (25 inch, 1st edn, 1858–64). The conical-roofed tower can be seen in Thomas Annan's photograph published in John Guthrie Smith and John Oswald Mitchell, *The Old Glasgow Houses of the Old Glasgow Gentry*, Glasgow: James MacLehose & Sons, 1870, no. 57 (unpaginated).
- 30: For detailed descriptions and analysis of these interiors see Roger Billcliffe, *Charles Rennie Mackintosh: The Complete Furniture, Furniture Drawings and Interior Designs*, Moffat, Dumfriesshire: Cameron & Hollis, 4th edn, 2009 pp. 195–215; contemporary photographs The Hunterian, University of Glasgow: GLAHA 52599; GLAHA 52600; GLAHA 52601; GLAHA 52602; GLAHA 52603.
- 31: A photograph taken at the time of the devastating fire in July 1934 shows the 1908–10 bay addition. John Weyers, 'Kate Cranston and the Mackintosh Connection', *Glasgow Herald*, 6 June 1981, 'Weekender' supplement, p. 7; *Glasgow Herald*, 6 July 1934, pp. 5 (photograph), 11; Roger Billcliffe, *Charles Rennie Mackintosh: The Complete Furniture, Furniture Drawings and Interior Designs*, Moffat, Dumfriesshire: Cameron & Hollis, 4th edn, 2009, pp. 244–8.
- 32: Mackintosh's labelling of the elevation orientations is incorrect: N. should be W. (or more precisely N.W.); S. should be E.; E. should be S.; and W. should be N.: Glasgow School of Art archive: elevations and sections, MC:G47 (M243-002).
- 33: David Walker, 'The Early Work of Charles Rennie Mackintosh', in Nikolaus Pevsner, 'Charles Rennie Mackintosh', in N. Pevsner, *Studies in Art, Architecture and Design, vol.2: Victorian and After*, London: Thames & Hudson, 1968, p. 129.
- 34: See annotations on plan and elevation. Glasgow School of Art archive: MC:G47 (M243-002).
- 35: See for instance, The Hunterian, University of Glasgow: GLAHA 41112; Emily V. Davis, 'Mackintosh, Hous'hill and the mysterious Card Room', *Charles Rennie Mackintosh Society Newsletter*, 87, Autumn 2004, pp. 6–9.
- 36: Emily V. Davis, 'Mackintosh, Hous-hill and the mysterious Card Room', *Charles Rennie Mackintosh Society Newsletter*, 87, Autumn 2004, p. 8.
- 37: Peter Wylie Davidson, 'Memories of Mackintosh', *Charles Rennie Mackintosh Society Newsletter*, no. 22, Summer 1979, p. 5; Thomas Howarth, *Charles Rennie Mackintosh and the Modern Movement*, London: Routledge & Kegan Paul, 2nd edn, 1977, p. 114; the job-book entries for the contractor responsible for all aspects of the fireplace, J. Caird Parker, verify the use of glass in the surround.
- 38: Roger Billcliffe, *Charles Rennie Mackintosh: The Complete Furniture, Furniture Drawings and Interior Designs*, Moffat, Dumfriesshire: Cameron & Hollis, 4th edn, 2009, p. 246; Hunterian, University of Glasgow: GLAHA 41770.
- 39: Detailed descriptions and analysis of the card room can found in Roger Billcliffe, *Charles Rennie Mackintosh: The Complete Furniture, Furniture Drawings and Interior Designs*, Moffat, Dumfriesshire: Cameron & Hollis, 4th edn, 2009, pp. 244–8; D1909.12 shows the writing table and two chairs intended for the card room bay; see also Emily V. Davis, 'Mackintosh, Hous-hill and the mysterious Card Room', *Charles Rennie Mackintosh Society Newsletter*, no. 87, Autumn 2004, pp. 6–9. Sketches for Hous'hill card-room furniture and fireplace ironwork can be found in Mackintosh's travel sketchbooks, Hunterian, University of Glasgow: GLAHA 53014/18 and 53014/48. The four gesso panels (now in the collection of Virginia Museum of Fine Arts, Richmond, Virginia, USA) make a brief appearance in a film on Mackintosh, released in 1965 (11:44–57): *Charles Rennie Mackintosh*, dir. by Louise Annand and William Thomson, Scottish Educational Film Association (SEFA), 1965, ssa.nls.uk [accessed 23 January 2012], Edinburgh: Scottish Screen Archive, National Library of Scotland, no. 0090.
- 40: Two drawings of 'The Hous'hill, Nitshill' were exhibited at the Glasgow Institute of the Fine Arts in 1909 (686 and 690). As the *Glasgow Herald* critic did not mention these in the review of the exhibition, it is not known whether these were architectural drawings.

- 41: Perilla Kinchin, *Miss Cranston: Patron of Charles Rennie Mackintosh*, Edinburgh: National Museums of Scotland, 1999, p. 82.
- 42: Roger Billcliffe, *Charles Rennie Mackintosh: The Complete Furniture, Furniture Drawings and Interior Designs*, Moffat, Dumfriesshire: Cameron & Hollis, 4th edn, 2009, pp. 244–5.
- 43: Glasgow City Archives Collection: Glasgow Corporation, Housing Department, sites and building sub-committee minutes, C1/3/93, 5 October 1934.
- 44: Glasgow City Archives Collection: Glasgow Corporation, Housing Department, sites and building sub-committee minutes, C1/3/96, 8 January 1937.
- 45: Glasgow City Archives Collection: Glasgow Corporation, Housing Department, sites and building sub-committee minutes, C1/3/97, 3 December 1937; C1/3/100, 19 May 1939.
- 46: O.S., Renfrewshire XII.SE (County Series 1:10560, 3rd revision, 1938–47).
- 47: Includes billiard marker £1 10s 0d.
- 48: Includes 'seats at fireplace' and 'high seats'.
- 49: Includes: 4 chairs at 40/- each; card table; frieze rail etc.
- 50: 'Gas Brackets' and 'Central Pendant'.
- 51: Includes: 'glass for White Bedroom lamps' £4 0s 0d ; 'glass for Blue Bedroom lamps' £6 10s 0d; drawing room lamps £4 15s 0d; drawing room pendant £9 0s 0d; glass panels for billiard room; 'Dining Room & Drawing Room frieze rail'; 'Mosaic Panels Drawing Room!; glass for fireplaces; 'Glass for Drawing Room Screen 6/- each' £10 16s 0d.
- 52: Includes: six panels for drawing room cupboards £4 10s 0d; one panel for drawing room cupboard £2 10s 0d.
- 53: One panel for writing table in white bedroom
- 54: One panel for writing table in blue bedroom
- 55: One panel for washstand in blue bedroom
- 56: Two panels for blue bedroom cupboards.
- 57: Cost of grates and fenders in drawing room, white bedroom, blue bedroom, dining room, billiard room, and 'Claverhouse Room!', and poker, tongs and shovel.
- 58: Total cost of lamps for white bedroom, blue bedroom, spare bedroom and drawing room
- 59: Only the cost of hat and coat hooks for the hall is recorded. Tender also includes lamps of various forms, towel rails and brackets.
- 60: Only the cost of the glass beads is recorded. Tender also includes hall lamps.
- 61: Total cost of curtains for billiard room and dining room, embroidery for dining room and counterpanes for the white bedroom and blue bedroom
- 62: Total cost of a wardrobe, couch, dining table, bed, washstand, cupboards, various tables and several chairs.
- 63: Total cost of eight basins and eight jugs.
- 64: Total cost of candlestick cups and mother of pearl work in drawing room
- 65: Tender for hair carpets for stairs, hall, vestibule and kitchen.
- 66: Tender for 'ware in Blue Bedroom!.
- 67: Total cost of 2 x bed, chest of drawers, washstand, mirror and chairs, a writing cabinet and a square table.
- 68: Total cost of mantelpiece and fender, alterations to wardrobe and skirting board.
- 69: Tender for square table for drawing room
- 70: Total cost of drawing-room screen and fireplace.
- 71: Tender for alterations.
- 72: Total cost of drawing room cabinets and revolving bookcase.
- 73: Total cost of an armchair and four small chairs for drawing room.

- 74: Tender includes carpets, stair rods and door strips, and expenses of laying carpets.
- 75: Tender for cushions for drawing room and blue bedroom
- 76: Tender for shelf in billiard room and 'putting in mother of pearl'.
- 77: Total cost of shelf in billiard room and 'fixing mother of pearl' in drawing room.
- 78: Dining room carpet.
- 79: Billiard room carpet.
- 80: Lamps and glass panels and inserts for various items of furniture.
- 81: Work to grates, fenders, hearths and fireplaces in various rooms, and jobbing.
- 82: Lampshades, brackets and pendants in various rooms, and fitting.
- 83: Drawing room carpet, special felt and expenses.
- 84: Four pairs of window screens for the drawing room.
- 85: Drawing room screen, cupboard, circular seats and fireplace.
- 86: Eight cushions for drawing room
- 87: Includes wardrobe, settle, bed, washstand and various tables and chairs.
- 88: Three candlesticks.
- 89: Donegal rug for blue bedroom and special felt.
- 90: Fireplace, skirting, lining and plate.
- 91: Two basins and two jugs each for the blue bedroom and the white bedroom.
- 92: Five cups for candlesticks.
- 93: Four pairs of window curtains, two pairs of bed curtains, valance and head sheets for the blue bedroom, and fitting.
- 94: Mason, joiner and plaster work.
- 95: 'Blue Bedroom ware'.
- 96: Mother of pearl work in drawing room
- 97: Includes two beds, washstands, chests of drawers, mirrors and chairs, a writing cabinet and square table.
- 98: Work to mantelpiece and press door.
- 99: Includes rugs, felt, feather bolsters and down pillows.
- 100: Table, revolving bookcase and two cabinets for drawing room.
- 101: Small seats for drawing room, circular seats, door handles and covering fender in 'Claverhouse Room'.
- 102: Two pairs of window screens, curtains, valances and head sheets for the white bedroom, and fitting.
- 103: Includes jobbing, hall and stair frieze rail, vestibule door and dining room 'finger rail'.
- 104: Linoleum, 40 pairs of window curtains and 'rods for windows'.
- 105: Dining room pendants.
- 106: Hall dresser.
- 107: Hair carpets, stair rods, pins and sockets, and one yard of linen for the blue bedroom.
- 108: Six cushions for the drawing room, two for the blue bedroom and a table centre for the blue bedroom.

- 109:** 'Blue Bedroom tow[e] rail'.
- 110:** Two chairs for the blue bedroom.
- 111:** Shelf in billiard room and fixing mother of pearl.
- 112:** Drawing room candelabra, staircase lanterns, six hat and coat hooks, fitting and jobbing.
- 113:** Includes 'tiles for Dining Room grate', 'lead covered kerb' for dining room grate, pokers and pairs of tongs.
- 114:** Four wrought-iron and glass lanterns, gas piping and fitting.
- 115:** 'not including roughcasting on old walls 1/10 per yard'.
- 116:** 'including pantry fittings'.
- 117:** 'Card Room & centre stand'.
- 118:** '4 @ £5 13/- each'.
- 119:** 'Block flooring in Kitchen etc'.
- 120:** 'Card Room floor'.
- 121:** Includes 'glass & cement at sides & top including hearth' £8 7s 6d.
- 122:** 'tiles at kitchen range'.
- 123:** 'Trellis at Balcony'.
- 124:** Includes : 2 'Box Lanterns between Kitchen and Card Room', 'no interior fittings allowed'; 2 ceiling fittings in Card Room 'with inverted gas burners'.
'To this [?] to be added inverted lights in Lanterns and wiring of lower edge of ceiling lights and fitting up'.
- 125:** Includes an easy chair (£5 0s 0d) and a table (£6 15s 0d) for the 'White Room'.
- 126:** 'Bronze Handles'
- 127:** 'White metal candlestick'.
- 128:** '4 Gesso Panels'.
- 129:** Includes: 'White Metal Candlestick' £13 4s 0d; 'fitting etc' £1 6s 0d
- 130:** '5 flower tubes'.
- 131:** Includes: 'special estimate' for pantry fittings £34 0s 0d, 'alterations above Entrance Porch' £10 15s 0d and 'Rose Trellis' £2 10s 0d; 'Work done in connection with outside Building not instructed by us' £74 0s 3½d.
- 132:** Includes 'Glass, Grates etc'.
- 133:** For fitting up lights.
- 134:** For candlestick.
- 135:** '4 Panels'.
- 136:** '5 Flower Tubes'.
- 137:** 'Part chargeable by us £104.17.11. Part authorized by Mr Cochrane 82 13 4'.

Mackintosh Architecture: Context, Making and Meaning

Led by The Hunterian, University of Glasgow, funded by the Arts and Humanities Research Council; with additional support from The Monument Trust, The Pilgrim Trust, and the Paul Mellon Centre for Studies in British Art; and collaborative input from Historic Scotland and the Royal Commission on the Ancient and Historical Monuments of Scotland.



[© copyright 2014](#)

[Contact us](#)